

ABACOA - CENTRAL BOULEVARD PLAT

157

A Portion of Sections 13 and 14, Township 41 South, Range 42 East
Town of Jupiter, Palm Beach County, Florida

March 1999

This Instrument prepared by James E. Park, P.S.M.
Williams, Hatfield & Stoner, Inc. - Engineers Surveyors Planners Environmental Scientists
1901 South Congress Avenue, Suite 150, Boynton Beach, Florida 33426

Sheet 6 of 6

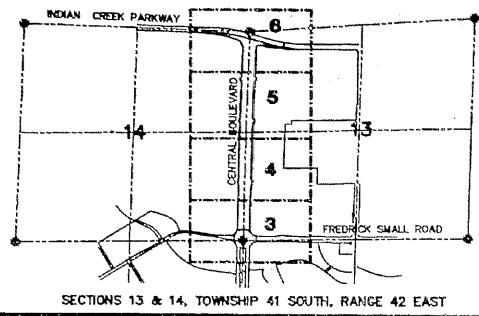

LOCATION MAP

